

FAA L-810 Obstruction Light

AV-OL Series Universal AC or Universal DC Single Light Fixture



Features

- Cost effective, energy efficient obstruction lighting solution
- Available in universal DC: will accept between 12-48VDC
- Available in universal AC: will accept between 110-240VAC
- User-adjustable operation mode to toggle between dusk-till-dawn & 24hr operation
- Alarm contact for remote monitoring
- Light sensor for day/night operation
- LED technology reduces maintenance time and costs
- Easily retrofits with existing installations
- Optional solar powered configurations available
- Optional combined visual/IR for pilots using NVG
- Optional RS422/485 communications port for monitoring DC version

Applications

- Obstruction lighting

Compliance

- Certified to FAA AC150/5345-43G for L-810 Steady-burning Red Obstruction Light
- FAA Engineering Brief No. 67D

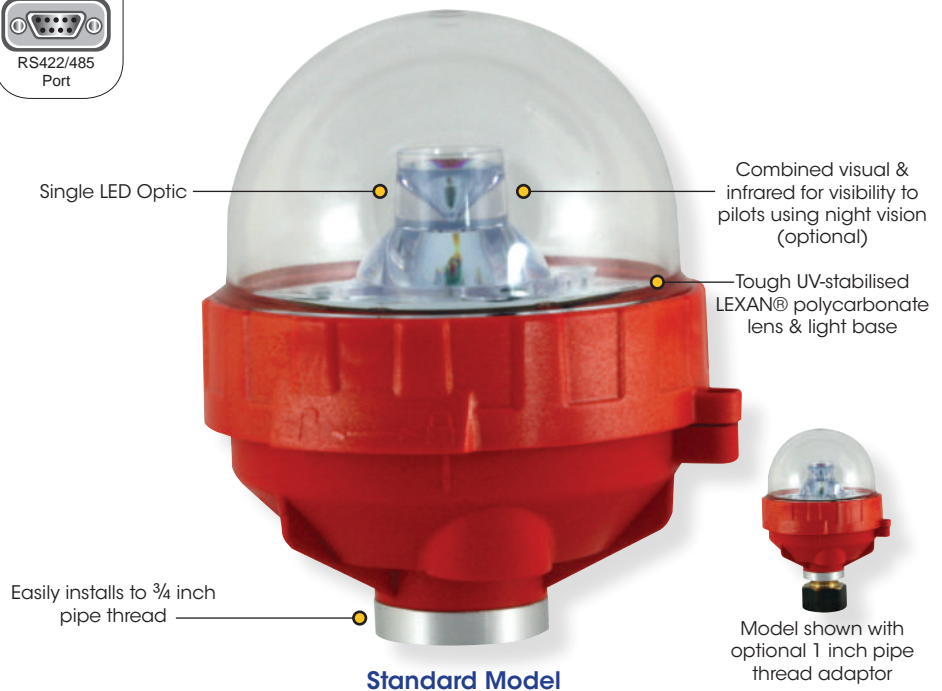

This Avlite light fixture is a steady burning, low intensity LED obstruction light designed to comply with FAA L-810 requirements. The model can be used for marking obstacles which pose a threat to aircraft, such as telecommunication towers, wind turbines, buildings and other tall structures.

Avlite's LED obstruction lights offer an ultra bright, energy efficient and cost effective lighting solution. The light fixture is available in two configurations, universal DC (12-48VDC) or universal AC (110-240VAC).

The advanced light optic uses a single LED for minimal power consumption. The corrosion resistant, polycarbonate lens is specifically designed for use with LEDs to maximize light intensity and uniformity.

The light fixture incorporates internal diagnostic checking and an alarm contact for remote monitoring. The alarm relay is energised in normal operation and is released if there is an LED or power fault.

The unit is available with either a 3/4 or 1 inch thread type - making it simple to retrofit with existing installations.

The obstruction light also has an adjustable operation mode setting to allow the user to easily toggle between dusk-till-dawn and 24 hour operation modes.

The obstruction light is also available with combined visual and infrared (IR) for visibility to pilots using night vision.

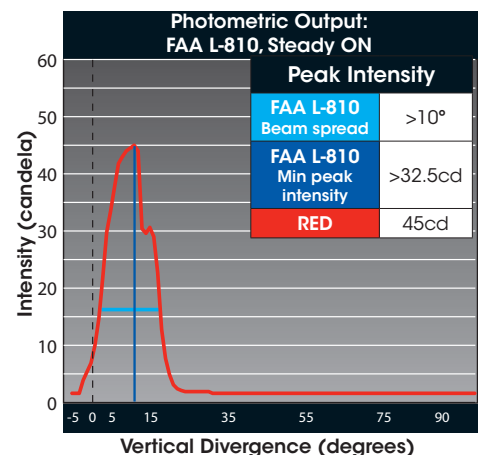

Avlite Systems
AUSTRALIA
t: +61 (0)3 5977 6128

USA
t: +1 (603) 737 1310

w: www.avlite.com
e: info@avlite.com



FAA L-810 Obstruction Light

AV-OL Series Universal AC or Universal DC Single Light Fixture

SPECIFICATIONS * *

Light Characteristics

Light Source
Available colors
Peak Intensity (cd) †
Horizontal Output (degrees)
Vertical Divergence (degrees)
Reflector Type
Intensity Adjustments
Operation Mode Adjustment

LED Life Expectancy (hours)

Electrical Characteristics

Operating Voltage
Current Draw (mA)

Power (W)

Circuit Protection
Temperature Range

Physical Characteristics

Body Material

Lens Material

Lens Diameter (mm/inches)

Lens Design

Mounting

Height (mm/inches)

Width (mm/inches)

Mass (kg/lbs)

Product Life Expectancy

Environmental Factors

Humidity

Icing

Wind Speed

Certifications

CE

Quality Assurance

FAA

Waterproof

Intellectual Property

Trademarks

Warranty * *

Options Available

12-48 VDC

As tested;
FAA: AV-OL-FL810-12-R LED
Red as standard. Other colors available on request, including IR
Complies with FAA L-810 obstruction lights
360
As per FAA L-810 obstruction light specification
Single LED Optic
32.5cd
User-adjustable between dusk-fill-dawn & 24 hour operation
>100,000

12 - 48 VDC
@ 12V:
FAA L-810 @ 32.5cd Steady-on with relay energised & IR: I_{max} = 135
FAA L-810 @ 32.5cd Steady-on with relay energised & IR: P_{max} = 1.75

Integrated
-40 to 80°C

LEXAN® Polycarbonate - UV stabilized
LEXAN® Polycarbonate - UV stabilized
100 / 3⁷/₈
Single LED Optic
Standard Model: ¾ inch pipe thread
Standard Model: 137 / 5½
121 / 4³/₈
0.4 / 7⁸/₁₆
Up to 12 years

0 to 100%, MIL-STD-810F
22kg per square inch
Up to 240kph

EN61000-6-3:1997. EN61000-6-1:1997
ISO9001:2008
L-810 Steady-burning Red Obstruction Light
(Qualified by Intertek)
IP67

AVLITE® is a registered trademark of Avlite Systems
3 year warranty
• Variety of solar/battery configurations
• Dual visual/IR output
• IR LED
• RS422/485 communications port
• Threaded adaptor to fit one (1) inch pipe

110-240 VAC

As tested;
FAA: AV-OL-FL810-UM-R LED
Red as standard. Other colors available on request, including IR
Complies with FAA L-810 obstruction lights
360
As per FAA L-810 obstruction light specification
Single LED Optic
32.5cd
User-adjustable between dusk-fill-dawn & 24 hour operation
>100,000

110 - 240 VAC
n/a
FAA L-810 @ 32.5cd Steady-on with relay energised: P_{max} = 3
S_{max} = 8VA
Integrated
-40 to 80°C

LEXAN® Polycarbonate - UV stabilized
LEXAN® Polycarbonate - UV stabilized
100 / 3⁷/₈
Single LED Optic
Standard Model: ¾ inch pipe thread
Standard Model: 137 / 5½
121 / 4³/₈
0.4 / 7⁸/₁₆
Up to 12 years

0 to 100%, MIL-STD-810F
22kg per square inch
Up to 240kph

EN61000-6-3:1997. EN61000-6-1:1997
ISO9001:2008
L-810 Steady-burning Red Obstruction Light
(Qualified by Intertek)
IP67

AVLITE® is a registered trademark of Avlite Systems
3 year warranty
• Dual visual/IR output
• IR LED
• Threaded adaptor to fit one (1) inch pipe

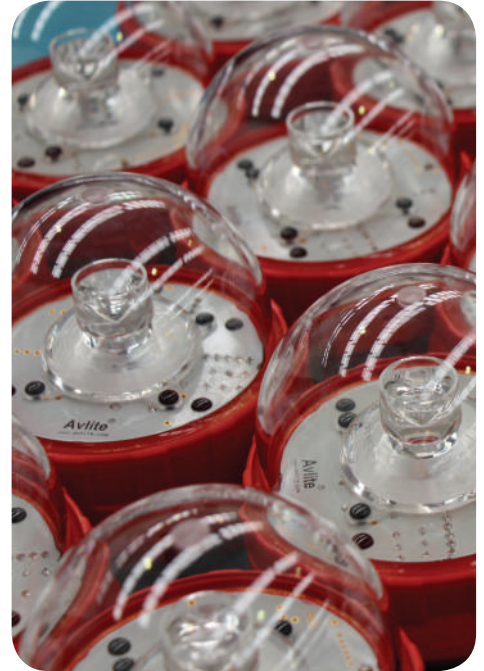

HOW TO ORDER

FAA Compliant

AV-OL-FL810-[Model]-[Color]-[?]

Product No.:

Model:

12 = 12-48 VDC
UM = 110-240 VAC

Color:

R = Red
IR = Infrared
RIR = Combined Red/IR

RS Communications Port:

RS = RS communications port
[blank] = No RS communications port

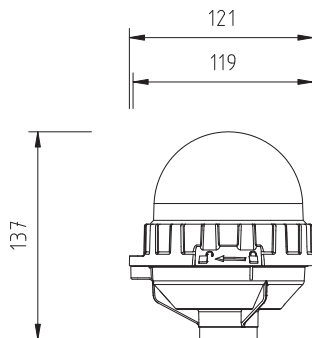

Standard Model

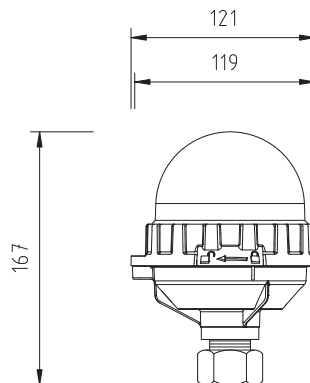

Model shown with optional
1 inch pipe thread adapter