

CASA Low Intensity Obstruction Light

AV-OL Series Universal AC or Universal DC Light Fixture

Features

- Cost effective, energy efficient obstruction lighting solution
- Available in universal DC: will accept between 12–48VDC
- Available in universal AC: will accept between 110–240VAC
- Alarm contact for remote monitoring
- Light sensor for day/night operation
- LED technology reduces maintenance time and costs
- Provision for external hardware synchronisation
- Optional solar powered configurations available
- Optional onboard GPS receiver for synchronisation
- Optional GSM monitoring (VDC model only)
- Optional general purpose I/O with galvanic isolation
- Optional RS422/485 communications port for monitoring

Applications

- Low Intensity Obstruction Light for marking obstacles up to 45 metres in height

Compliance

- Civil Aviation Safety Authority of Australia (CASA) Manual of Standards Part 139 - Aerodromes, Version 1.11 November 2013



This Avlite light fixture is a steady-on, low intensity LED obstruction light designed to comply with CASA LIOL requirements. The model can be used for marking obstacles up to 45 metres above ground.

Avlite's LED obstruction lights offer an ultra bright, energy efficient and cost effective lighting solution. The light fixture is available in two configurations, universal DC (12-48VDC) or universal AC (110-240VAC).

The advanced light optic uses a multiple, high intensity LEDs for efficient operation. The corrosion resistant, polycarbonate lens is specifically designed for use with LEDs to maximize light intensity and uniformity.

The light fixture incorporates internal diagnostic checking and an alarm contact for remote monitoring. The alarm relay is energised in normal operation and is released if there is an LED or power fault.



Heavy duty, cast aluminium base

Optional GSM Monitoring & Control (VDC model only)

The Avlite obstruction light is available with GSM Cell-Phone Monitoring, enabling operators to remotely monitor the status of their installation. The system can also be configured to send out SMS text messages or e-mail alerts to designated operators should alarm conditions be triggered, such as low voltage or light failure.

Optional GPS Synchronisation

Avlite has utilized the latest advancements in GPS technology to develop an internal synchronisation system that can be incorporated into the lights if set to flashing. Using overhead satellites, multiple obstruction lights set to the same flash pattern will flash in unison.

Optional RS422/RS485 Monitoring

The obstruction light is available with RS422/485 monitoring functionality, enabling operators to monitor the status of the unit in real-time. The system tracks critical application specific parameters including alarm status, LED status, operation mode, intensity, flash code and source voltage.

CASA Low Intensity Obstruction Light

AV-OL Series Universal AC or Universal DC Light Fixture

SPECIFICATIONS * *

	12-48 VDC	110-240VAC
	AV-OL-CL-12-R	AV-OL-CL-UM-R
Light Characteristics		
Available colors	Red as standard. Other colors available on request	Red as standard. Other colors available on request
Peak Intensity (cd)†	Complies with CASA LIOL. 100cd	Complies with CASA LIOL. 100cd
Horizontal Output (degrees)	360	360
Vertical Divergence (degrees)	>10. 100cd minimum at +6° and +10° above the horizontal. Not less than 10cd at all elevation angles between -3° and +90° above the horizontal.	>10. 100cd minimum at +6° and +10° above the horizontal. Not less than 10cd at all elevation angles between -3° and +90° above the horizontal.
Available Flash Characteristics	Steady-on. Flash rates available on request	Steady-on. Flash rates available on request
Electrical Characteristics		
Operating Voltage	12 - 48VDC	110 - 240VAC
Power (Watts)	17W	20W
Circuit Protection	Integrated	Integrated
Temperature Range	-40 to 80°C	-40 to 80°C
Physical Characteristics		
Body Material	7-stage powder-coated aluminium	7-stage powder-coated aluminium
Lens Material	LEXAN® Polycarbonate - UV stabilized	LEXAN® Polycarbonate - UV stabilized
Lens Diameter (mm/inches)	171 / 6¾	171 / 6¾
Lens Design	Multi LED Optic	Multi LED Optic
Mounting	200mm bolt pattern	200mm bolt pattern
Height (mm/inches)	151 / 6	151 / 6
Width (mm/inches)	230 / 9	230 / 9
Mass (kg/lbs)	5 / 11	5 / 11
Product Life Expectancy	Up to 12 years	Up to 12 years
Environmental Factors		
Humidity	0 to 100%, MIL-STD-810F	0 to 100%, MIL-STD-810F
Icing	22kg per square inch	22kg per square inch
Wind Speed	Up to 240kph	Up to 240kph
Certifications		
CE	EN61000-6-3:1997. EN61000-6-1:1997	EN61000-6-3:1997. EN61000-6-1:1997
Quality Assurance	ISO9001:2008	ISO9001:2008
Waterproof	IP67	IP67
Intellectual Property		
Trademarks	AVLITE® is a registered trademark of Avlite Systems	AVLITE® is a registered trademark of Avlite Systems
Warranty * Options Available	3 year warranty • Variety of solar/battery configurations • GSM Cell-Phone Monitoring • GPS Synchronisation • RS422/485 communications port	3 year warranty • GPS Synchronisation • RS422/485 communications port

Characteristics of CASA Low Intensity Obstacle Lights

CASA low intensity obstacle lights, for general applications, are to have the following characteristics:

- Fixed lights showing red
- a horizontal beam spread that results in 360° coverage around obstacle
- a peak intensity of 100cd minimum
- a vertical beam spread (to 50% of peak intensity) of 10°
- a vertical distribution with 100cd minimum at +6° and +10° above the horizontal
- not less than 10cd at all elevation angles between -3° and +90° above the horizontal

Note: the intensity level is higher than ICAO standards because in Australia only obstacles assessed as significant to aircraft operations are required to be provided with obstacle lighting

References: Civil Aviation Safety Authority (CASA) Manual of Standards Part 139 - Aerodromes, Version 1.11 November 2013

HOW TO ORDER

CASA Compliant LIOL

AV-OL-CL-[?]-[R]-[?]-[?]

Product No.: _____

Model: _____
 12 = 12-48 VDC
 UM = 110-240 VAC

Color: _____
 R = Red
 Note: other colours available on request

Monitoring & Control: _____
 GSM = GSM (VDC model only)
 GPS = GPS Synchronisation
 [blank] = No monitoring & control

RS Communications Port: _____
 RS = RS communications port
 [blank] = No RS communications port

Note: Please contact your Avlite representative for optional power supply solutions

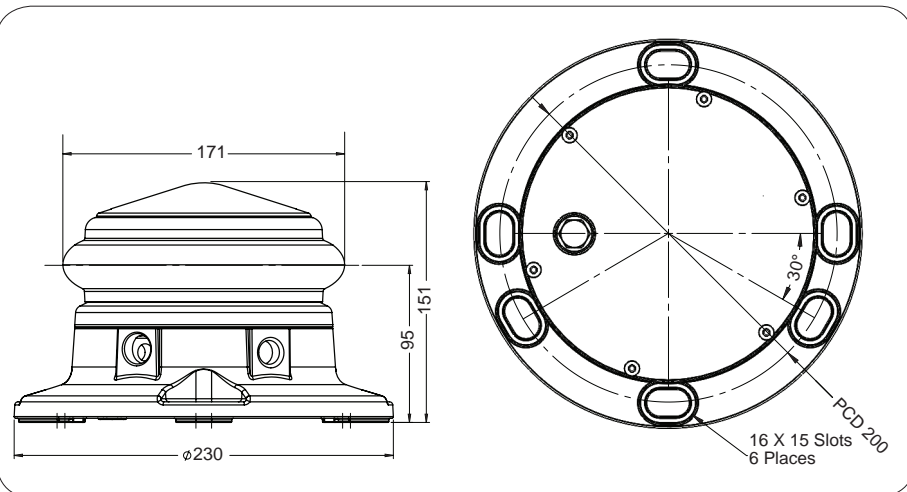

* Specifications subject to change or variation without notice
 † Subject to standard terms and conditions
 ‡ Intensity setting subject to solar availability

