

# Helipad Floodlight

AV-FL-DC

## Features

- Universal DC: will accept between 10-30VDC
- High intensity, energy efficient LEDs
- Low profile to suit industry requirements
- Custom lens optic designed specifically for helipad operations
- Angle of tilt of the luminaire is easily adjusted to maximise helipad illumination
- Weather resistant enclosure
- 110-240VAC option available via step-down transformer

**New Product**

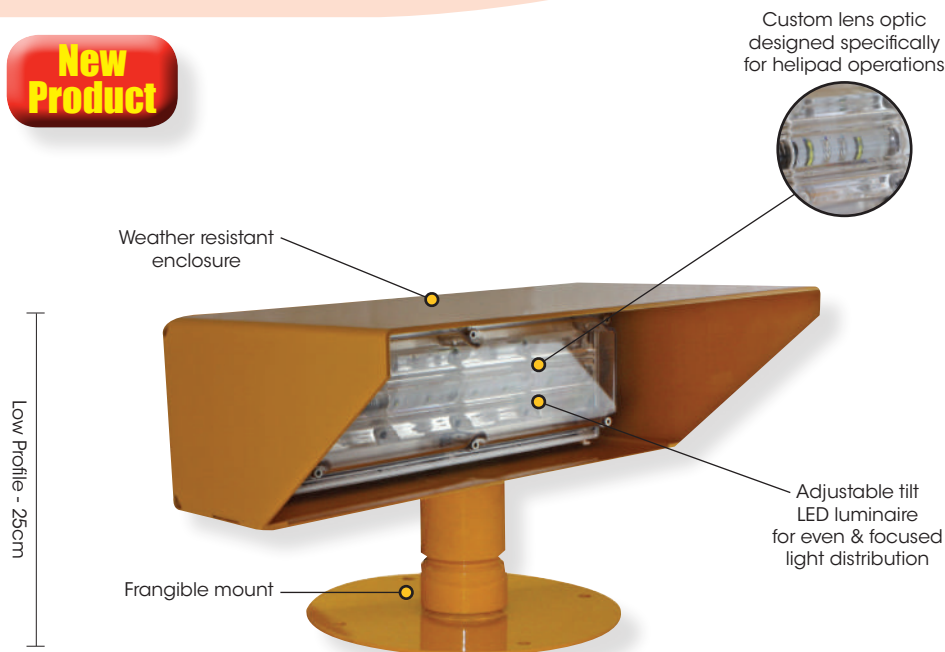

**Avlite's universal DC floodlight has been specifically designed for helipads to provide uniform surface lighting where the TLOF and FATO lights need to be supplemented with floodlighting. It offers a 10-30VDC, LED based solution to the ICAO touchdown and lift-off area perimeter floodlights.**

The LED optic is specifically designed for helipad operations, and distributes the light evenly across the wide helipad surface. The angle of tilt of the LED luminaire can be easily adjusted to focus the light on the helipad to maximise illumination. The optic hood further prevents potential glare to pilots upon approach.

Housed in a weatherproof, powder-coated aluminium enclosure to withstand the harshest of environments, the assembly has a low profile of less than 25cm and mounts to frangible points.



# Helipad Floodlight

AV-FL-DC

## SPECIFICATIONS\* \*

## AV-FL-DC

### Light Characteristics

Light Source LED  
 Available colors White, other colors available on request  
 LED Life Expectancy (hours) >100,000

### Electrical Characteristics

Current Draw (A) @ 12V: 1.7  
 Operating Voltage (V) 10 - 30  
 Circuit Protection Integrated  
 Temperature Range -40 to 80°C

### Physical Characteristics

Body Material 7-stage powder coated aluminium  
 Lens Material LEXAN® Polycarbonate - UV stabilized  
 Mounting Frangible mount  
 Height (mm/inches) 250 / 9¾  
 Length (mm/inches) 406 / 16  
 Width (mm/inches) 230 / 9  
 Mass (kg/lbs) 5 / 11  
 Product Life Expectancy Up to 12 years

### Environmental Factors

Humidity 0 to 100%, MIL-STD-810F  
 Icing 22kg per square inch  
 Wind Speed Up to 160kph

### Certifications

CE EN61000-6-3:1997, EN61000-6-1:1997  
 Quality Assurance ISO9001:2008  
 Waterproof (electronic enclosures) IP68

### Intellectual Property

Trademarks AVLITE® is a registered trademark of Avlite Systems

### Warranty \*

3 year warranty  
 • 110-240VAC operation available via step-down transformer

### Options Available

\* Specifications subject to change or variation without notice  
 • Subject to standard terms and conditions

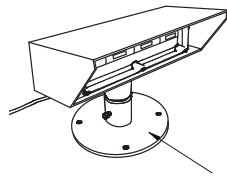

SKETCH  
 Base plate fixed to concrete pad

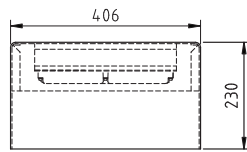

TOP

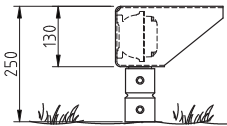

SIDE

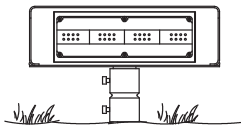

FRONT

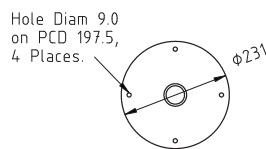

BASE PLATE

